

# Timer

## Pre-programmed DC connector

### Technical data:

- Input voltage range: 12-24VDC
- Max. output current: 1 Amp
- Max. current consumption: 4 mA (no load)
- Ambient temperature range: -25°C to +60°C
- Degree of protection acc. to DIN EN 60529: IP 65
- Pre-programmed time ranges ( $T_{ON}$ ,  $T_{OFF}$ ,  $T_{DELAY}$ ) :  
0,1 sec. to 250 hours (programmed by the factory\*)
- Timing accuracy:  $\pm 5\%$
- Built-in surge protection



### Timing types:

(programmed by the factory\*)

#### 1. Cycle timer, start with ON state

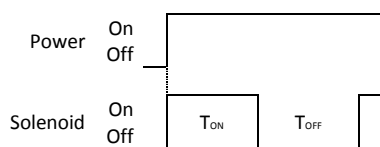

#### 2. Cycle timer, start with OFF state

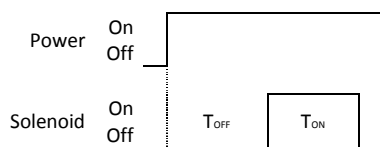

#### 3. Interval delay

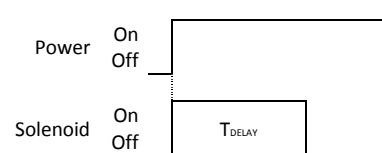

### Dimensional data:

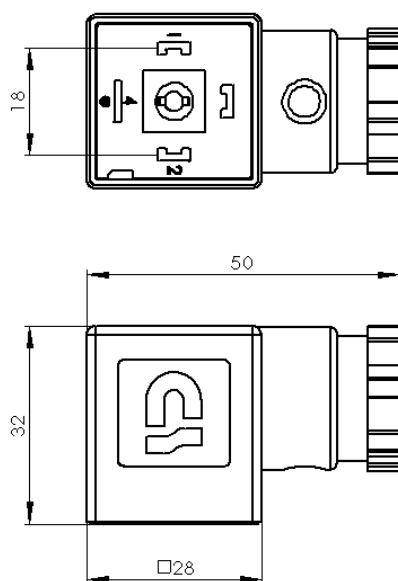

Form A (ISO 4400)

### Wiring:

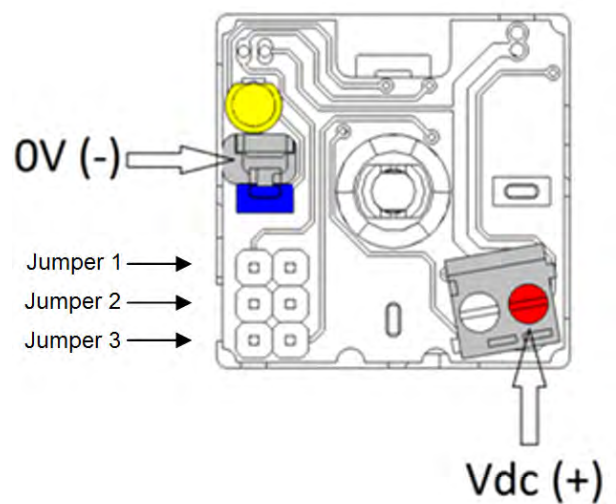

# Timer

## Pre-programmed, pre-wired AC connector

### Technical data:

- Input voltage range: 100-240 VAC (50/60 Hz)
- Max. output current: 0,4 Amp
- Max. timer current consumption: 2 mA (no load)
- Ambient temperature range: -25°C to +60°C
- Degree of protection acc. to DIN EN 60529: IP 65
- Pre-programmed time ranges ( $T_{ON}$ ,  $T_{OFF}$ ,  $T_{DELAY}$ ) :  
**0,1 sec. to 250 hours (programmed by the factory \*)**
- Timing accuracy:  $\pm 5\%$
- Built-in surge protection
- Pre-wired with 0,75mm<sup>2</sup> PVC cable, 3m

### Functionality:

- On state: ON STATE LED lights continuously, the output is powered on.
- Off state: OFF STATE LED is blinking every second, the output is powered off.

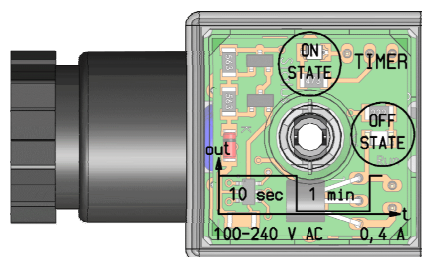

### Timing types:

(programmed by the factory \*)

#### 1. Cycle timer, start with ON state

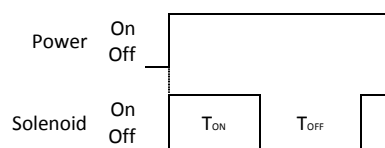

#### 2. Cycle timer, start with OFF state

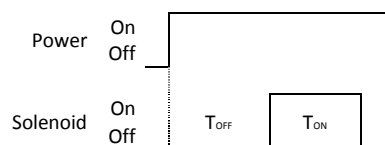

#### 3. Interval delay

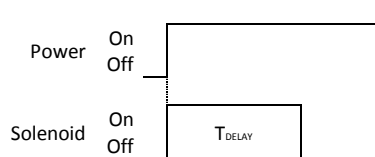

### Dimensional data:

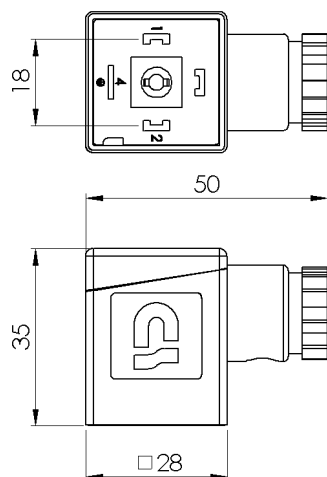

Form A (ISO 4400)

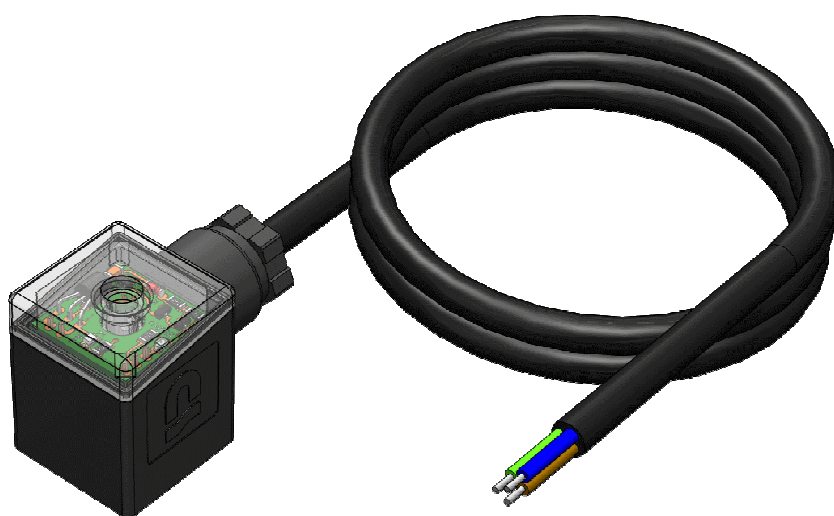

# Timer

(Instruction Sheet)

## Pre-programmed DC connector

### Technical data:

- Input voltage range: 12-24VDC
- Max. output current: 1 Amp
- Max. current consumption: 4 mA (no load)
- Ambient temperature range: -25°C to +60°C
- Degree of protection acc. to DIN EN 60529: IP 65
- Pre-programmed time ranges ( $T_{ON}$ ,  $T_{OFF}$ ) :  
0,1 sec. to 250 hours (programmed by the factory\*)
- Timing accuracy:  $\pm 5\%$
- Built-in surge protection

### Dimensional data:

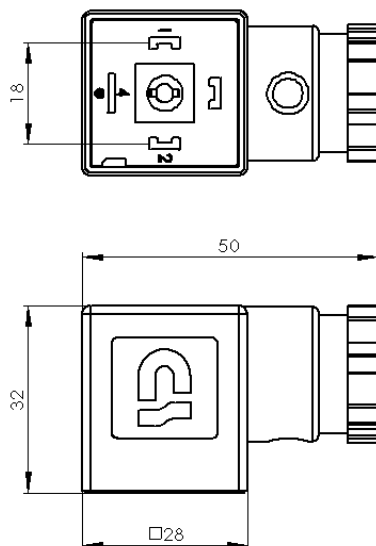

Form A (ISO 4400)

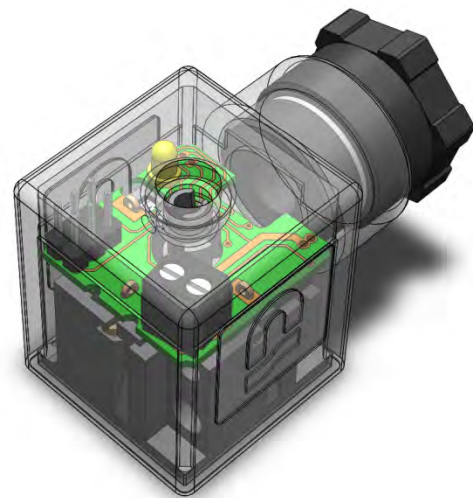

### Timing type:

Cycle timer, start with ON state

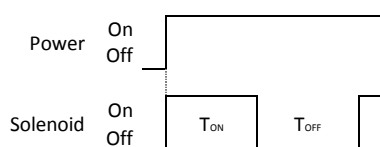

### Timing:

$T_{ON}=10\text{sec.}$

$T_{OFF}$ (min.)	1	2	3	4	5	6	7	8
Jumper 1	0	1	0	1	0	1	0	1
Jumper 2	0	0	1	1	0	0	1	1
Jumper 3	0	0	0	0	1	1	1	1

0: without jumper, 1: with jumper

### Wiring:

