

## Manometer MGE.R ø 40 - 50 - 63 - 80 mm

Pressure gauges suitable for all process gaseous and liquid that don't attack copper alloy parts. Intended for adverse service conditions where pulsating or vibration exists. Hydraulics, Compressors



### Description

Pressure gauge made according UNI EN 837.1 norms

- Stainless steel case aisi 304 dial - Dial 40 - 50 - 63 mm. protection degree IP65
- Glycerine filled (ph. 99.5% Vegetal origin)
- BRASS Spring, movement and pivot
- BOTTOM execution
- conical (UNI EN 10226) connection on dial 40 - cilindrical (ISO 228) connection on dial 50 and 63
- Aluminium index, Aluminium dial White background
- Black BAR scale and Red PSI (except compoud gauge)
- Accuracy 2,5% on dial 40 and 50 - Accuracy 1,6% on dial 63

### Using range

Working Temperature: -10 +60° C (+14 +140° F)

Working Pressure: Steady 75% - Variable 60%

Overpressure: 25% < 60 bar >15% (according EN837.1)

### Models

Normalized range: Vacuum -1 / 0 Bar+CmHg;

Compound -1+0,6; -1+1,5; -1+3; -1+5; -1+9; -1+15 BAR only;

0,6; 1; 1,6; 2,5; 4; 6; 10; 12; 16; 25; 40; 60; 100; 160; 250; 315; 400; 600; 1000 Bar + Psi

### Options

NPT ANSI B.1.20.1 thread, With or without Glycerin, OXYGEN SERVICE, customize range, scale or logo;

Coloured sector; Bottom conection @ 3 / 9 / 12 hours; refrigerants range with UNF connection

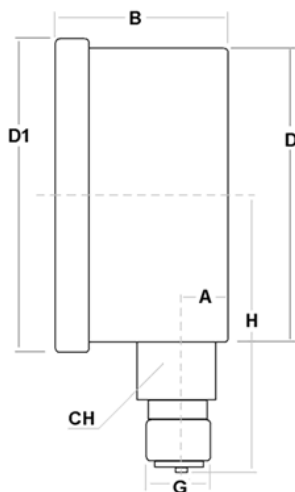

VAR	A	B	D	D1	H	G	CH	Kg	Lotto
dn 40	0,5	25	40,5	44	38	1/8" BSPT		11	0,110 100
dn 50	10	30	52	57	49	1/4" BSPP		14	0,145 100
dn 63	10	30	62	68	57	1/4" BSPP		14	0,207 50
dn 80	10	30	80	87	72	3/8" BSPP		17	0,290 50