

CARATTERISTICHE PRINCIPALI

Main features

TIPO Type	REGOLATORE DI PRESSIONE PER GAS TECNICI E LIQUIDI Pressure regulator for technical gas and liquids	
PRESSIONE DI ESERCIZIO Max. Inlet pressure	50 BAR	
Attacchi Connections	1/2" GF- 3/8" GF (NPT disponibile a richiesta / NPT available on request)	
TEMPERATURA DI ESERCIZIO Working temperature	-20°+80°C -4°+ 176°F	
PORTATA MASSIMA Maximum flowrate	~ 400 Nm³/h	
Kv (m³/h) CV (US gal/min)	2,99 (UNI EN 60534-2) 3.50	
RANGE PRESSIONI IN USCITA Outlet pressure ranges (bar)	0,2÷1,5 Modello a membrana in NBR + PTFE (PTFE a contatto con il fluido) 0,3÷3 Diaphragm model NBR+PTFE (PTFE in contact with the fluid) 0,8÷8 1,5÷15 3÷30 Modello a pistone 5÷50 Piston model	
PESO Weight	3,2 kg 7 lbs	
CLASSE DI TENUTA OTTURATORE Plug leakage class	Grado A (UNI EN 12266-1)	
CONNESSIONE MANOMETRO Gauge connection	1/4" G-F (with GAS in/out connections)	1/8" G-F / 1/8" NPT-F on request
CERTIFICAZIONI Certifications	PED 2014/68/UE ATEX dir. 2014/34/EU MOCA 1935/2004	

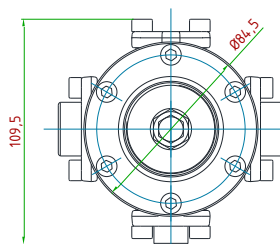
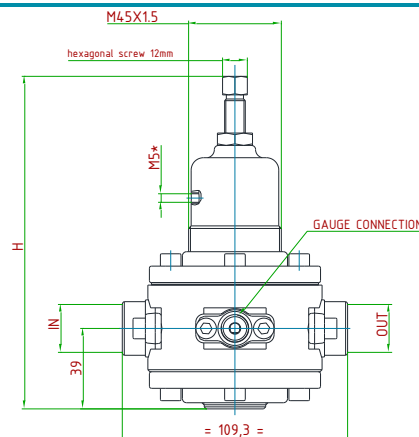

MODEL	OUTLET PRESSURE RANGE	H
DIAPHRAGM	0,2÷1,5 / 0,3÷3 / 0,8-8 / 1,5÷15 bar	-160mm
PISTON	3÷30 / 5÷50 bar	-178mm

IDONEO PER
Suitable for



MATERIALI

Materials

CORPO E PARTICOLARI INTERNI Body and internals	ACCIAIO INOSSIDABILE AISI 316L Stainless steel AISI 316L	
GUARNIZIONI E OTTURATORE Seals and plug	FPM	
MOLLA REGOLAZIONE Adjusting spring	ACCIAIO Stainless steel	

SU RICHIESTA

On request

MATERIALI GUARNIZIONI Seals material	EPDM NBR FVMQ	
ACCESSORI Accessories	MANOMETRO KIT STAFFA + GHIERA FUNZIONE RELIEVING	Outlet pressure gauge Kit bracket and ring-nut Relieving function

KIT DI RICAMBIO

Spare parts

CODICE / order code	312K2#...
CONTIENE The kit contains	O-RING, OTTURATORE ASSEMBLATO, FILTRO IN RETE, MEMBRANA ASSEMBLATA O-Rings, assembled plug, net filter, assembled diaphragm

CURVE DI PORTATA

Flow charts

PRESSIONE INGRESSO 10 bar (ARIA) / Inlet pressure 10 bar (air)

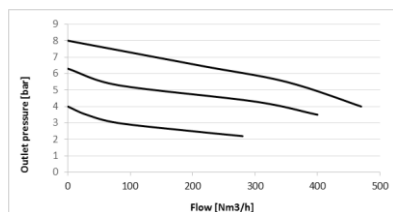

PRESSIONE USCITA / Outlet pressure: 1,5-15 bar

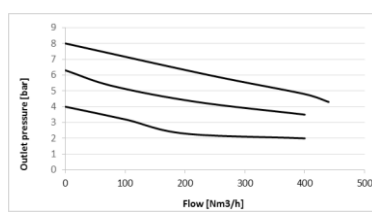

PRESSIONE USCITA / Outlet pressure: 0,8-8 bar

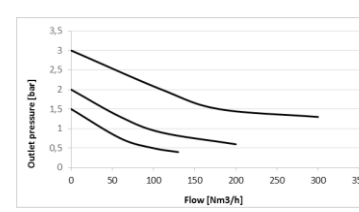

PRESSIONE USCITA / Outlet pressure: 0,3-3 bar



Azienda con sistema di gestione qualità certificato.
certificato N° 50 100 9191
Company with certificated quality management system.
certificate N° 50 100 9191

ID Insert Deal Srl
Strada dei Boschi, 40
20852 Villasanta (MB) Italia
tel. +39 039 30 2035
info@idinsertdeal.com

Subject to Change