

plastic push-in fittings for high performance

HMM

passaparete • bulkhead



CODE	001	002	T	A	E	B1	B2	H1(Hex)	H2(Hex)	L	Peso Weight(g)	
HMM 0604W	6	4	M17x1 ,SP	7,9	7,0	16,1		19	21		12,0	50
HMM 0606W	6	6	M17x1 ,SP	7,9	7,0	16,1	16,1	19	21	34,2	12,0	50
HMM 0806W	8	6	M20x1 ,75P	9,4	8,0	17,5	16,1	21	25,5	38,1	14,0	50
HMM 0808W	8	8	M20x1 ,75P	9,4	8,0	17,5	17,5	21	25,5	38,5	14,0	50
HMM 1010W	10	10	M24x1 ,75P	10,8	8,5	20,1	20,1	24	28,5	42,2	17,0	25
HMM 1212W	12	12	M27x2,0P	16,4	9,0	24,7	24,7	27	31	51,4	20,0	25

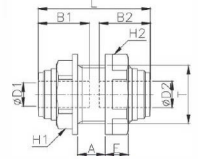

IMPERIAL TUBE

- Innesti rapidi in tecnopolimero per alte prestazioni
- Racores Automáticos en Termoplástico
- steckverschraubungen aus tecnopolymer raccords instantanés polymère
- Racores Automáticos en Termoplástico
- steckverschraubungen aus tecnopolymer raccords instantanés polymère

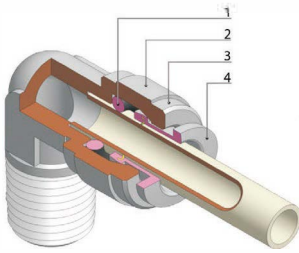

@
-20° C + 98° C Aria secca
-1° c + 98° C Aria & Fluidi



To -750mmHg at Max 20 Bar

RoHS2 1- JEACH



Construction Materials	Materiali Costruttivi	Construction Materials	Construction Materials	Construction Materials	Construction Materials
<p>1.0'Ring: EPDM 2.Body: POM 3.Cover: POM 4.Gripping Col/et: POM + STS301</p>	<p>1.0'Ring: EPDM 2.Corpo: POM 3.Cover: POM 4-6.Pinza di Tenuta: POM + STS301</p>	<p>1.0'Ring: EPDM 2.Body: POM 3.Cover: POM 4.Gripping Col/et: POM + STS301</p>	<p>1.0'Ring: EPDM 2.Body: POM 3.Cover: POM 4.Gripping Col/et: POM + STS301</p>	<p>1.0'Ring: EPDM 2.Body: POM 3.Cover: POM 4.Gripping Col/et: POM + STS301</p>	<p>1.0'Ring: EPDM 2.Body: POM 3.Cover: POM 4.Gripping Col/et: POM + STS301</p>
Data Sheet	Dati Tecnici	Data Sheet	Data Sheet	Data Sheet	Data Sheet
<p>Type Fluids: water, beverages, vacuum, compressed air, gases Threads: Taper gas BSPT ISO 7 from R1/8" to R1/2" Parallel gas BSPP ISO 228 from G1/8" to G1/2" Tubes Used: polyethylene (PE), polyamide (PA), polyurethane (PU), PTFE - FEP Soft metal tubes: brass, copper and mild steel Hard metal tubes: please contact our technical department for stainless steel and other hard materials tubes use</p>	<p>Fluidi Compatibili: acqua, bevande, vuoto, aria compressa, gas e liquidi Fifettature: Gas conica BSPT ISO 7 da R1/8" a R1/2" Gas cilindrica BSPP ISO 228 da G1/8" a G1/2" Tubi da utilizzare: polietilene (PE), poliammide (PA), poliuretano (PU), PTFE - FEP Tubi in metalli leggeri: ottone, ramee acciaio dolce Tubi in metalli duri: contattare l'ufficio tecnico per l'utilizzo con tubi in acciaio inox e altri metalli duri</p>	<p>Type Fluids: water, beverages, vacuum, compressed air, gases Threads: Taper gas BSPT ISO 7 from R1/8" to R1/2" Parallel gas BSPP ISO 228 from G1/8" to G1/2" Tubes Used: polyethylene (PE), polyamide (PA), polyurethane (PU), PTFE-FEP Soft metal tubes: brass, copper and mild steel Hard metal tubes: please contact our technical department for stainless steel and other hard materials tubes use</p>	<p>Type Fluids: water, beverages, vacuum, compressed air, gases Threads: Taper gas BSPT ISO 7 from R1/8" to R1/2" Parallel gas BSPP ISO 228 from G1/8" to G1/2" Tubes Used: polyethylene (PE), polyamide (PA), polyurethane (PU), PTFE-FEP Soft metal tubes: brass, copper and mild steel Hard metal tubes: please contact our technical department for stainless steel and other hard materials tubes use</p>	<p>Type Fluids: water, beverages, vacuum, compressed air, gases Threads: Taper gas BSPT ISO 7 from R1/8" to R1/2" Parallel gas BSPP ISO 228 from G1/8" to G1/2" Tubes Used: polyethylene (PE), polyamide (PA), polyurethane (PU), PTFE - FEP Soft metal tubes: brass, copper and mild steel Hard metal tubes: please contact our technical department for stainless steel and other hard materials tubes use</p>	<p>Type Fluids: water, beverages, vacuum, compressed air, gases Threads: Taper gas BSPT ISO 7 from R1/8" to R1/2" Parallel gas BSPP ISO 228 from G1/8" to G1/2" Tubes Used: polyethylene (PE), polyamide (PA), polyurethane (PU), PTFE-FEP Soft metal tubes: brass, copper and mild steel Hard metal tubes: please contact our technical department for stainless steel and other hard materials tubes use</p>



plastic push-in fittings for high performance

LEGENDA CODICE • Model designation

Filetta Canico BSPT • BSPT thread

HPC	06	R01
Cadice code	Diametro Tubo tube diameter	Filetta thread size
	04 4mm	R01 R1/8"
	06 6mm	R02 R1/4"
	08 8mm	R03 R3/8"
	10 10mm	R04 R1/2"
	12 12mm	

Filetta Cilindrico BSPP • BSPP thread

HPC	06	G01
Cadice code	Diametro Tubo tube diameter	Filetta thread size
	04 4mm	G01 G1/8"
	06 6mm	G02 G1/4"
	08 8mm	G03 G3/8"
	10 10mm	G04 G1/2"
	12 12mm	

DATI TECNICI • Technica/ specifications

Fluidi compatibili	Acqua potabile, bevande, aria compressa, vuoto, gas & liquidi compatibili con i materiali costruttivi
Materiali costruttivi	Corpo: POM Colletto: POM + SUS301 Guarnizioni: EPDM idoneo al contatto con alimenti
Filettature	Gas Conica BSPT ISO 7 da R1/8" a R1/2" Gas Cilindrica BSPP ISO 228 da G1/8" a G1/2"
Cappie di serraggia	1/8" & 1/4": 1,5 N/m - 3/8" & 1/2": 3,0 N/m
Pressiane d'esercizia	-750mmHg a 20 Bar
Temperatura d'esercizia	fino a 98°C

"C/mm	4	6	8	10	12
1 ° *	20 Bar	20 Bar	20 Bar	16 Bar	14 Bar
25 °C *	20 Bar	20 Bar	20 Bar	16 Bar	14 Bar
70 °C *	16 Bar	16 Bar	16 Bar	14 Bar	12 Bar
98 °C	10 Bar	10 Bar	10 Bar	8 Bar	6 Bar

Fluid types	Water, beverages, compressed air, vacuum, selected gases & liquid suitable with construction materials
Canstruction materials	Body: POM Collet: POM + SUS 301 Seals: EPDM suitable for food contact
Threads	Taper gas ISO 7 from R1/8" to R1/2" Parallel gas ISO 228 from G1/8" to G1/2"
Max tarque	1/8" & 1/4": 1,5 N/m - 3/8" & 1/2": 3,0 N/m
Warking pressure	From -750mmHg to 20 Bar
Warking temperature	From -20°C to +150°C

°C mm	4	6	8	10	12
1 °C *	20 Bar	20 Bar	20 Bar	16Bar	14Bar
25 °C *	20 Bar	20 Bar	20 Bar	16Bar	14Bar
70 °C *	16 Bar	16 Bar	16 Bar	14 Bar	12 Bar
98 °C	10 Bar	10 Bar	10 Bar	8 Bar	6 Bar

Tubi utilizzabili	Tubi plastici: Poliammide (PA) - Polietilene (PE) - PUES - PUET - PTFE - FEP (tolleranza ±0,1mm) Tubi in metalli leggeri: Ottone, ramee acciaio dolce Tubi in metalli duri: Contattare l'ufficio tecnico per l'utilizzo con tubi in acciaio inox e altri metalli duri
--------------------------	---

Applicable Tubes	Plastic tubes: polyamide (PA) - polyethylene (PE) PUES - PUET - PTFE - FEP (tolerance ±0,1mm) Soft metal tubes: Brass, copper and mild steel Hard metal tubes: please contact our technical department for stainless steel and other hard materials tubes use
-------------------------	--

RoHS Prodotti conformi alla direttiva 2002/95/EC
Prodotti conformi alla direttiva 1907/2006

RoHS Products in compliance with the directive 2002/95/EC
Products in compliance with the directive 1907/2006

plastic push-in fittings for high performance



ISTRUZIONI PER IL CORRETTO USO DEI RACCORDI

- Non utilizzare i raccordi di questa serie con fluidi diversi dall'aria.
- Si raccomanda di prevenire eventuali aumenti della pressione causati da vibrazioni, rotazioni e strappi del raccordo.
- Non utilizzare i raccordi in ambienti dove sono presenti scintille di saldatura.
- Vibrazioni o rotazioni improprie del raccordo possono compromettere la funzionalità e causare perdite. Scegliere il prodotto in base all'applicazione utilizzata tra l'ampia gamma di raccordi del nostro catalogo.
- Non utilizzare i raccordi se non direttamente a contatto con fluidi quali olio da taglio, olio lubrificante, olio refrigerante.



WARNING FOR FITTINGS RIGHT USE

- Do not use them on fluids other than air. We don't recommend or guarantee to use them for other purposes.
- Be sure to prevent pressure buildup caused by twisting, pulling and bending of the fitting product.
- Do not use the product where weid spatters occur as fire may break out.
- Product damage or air leakage may occur at places where there is rotation and vibration, choose the right product from our catalogue.
- Do not use the product where it is directly exposed to fluids such as cutting oil, lubricating oil and coolant oil.



PRECAUZIONI

- Assemblare i raccordi solo dopo aver eliminato eventuali impurità presenti



CAUTION

- Assemble the pipes only after clearing away impurities such as dust.