

## Fluidfit IMPERIAL TUBE

Fittings for potable water, drink dispenser, beverages

- Innesti rapidi in tecnopolimero per alte prestazioni
- Racores Automáticos en Termoplástico
- steckverschraubungen aus tecnopolymer raccords instantanès polymère
- Racores Automáticos en Termoplástico
- steckverschraubungen aus tecnopolymer raccords instantanès polymère

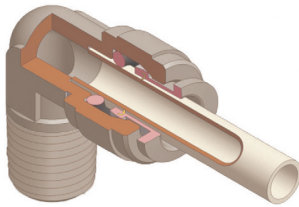

-20°C ÷ 98°C Aria secca  
-1°C ÷ 98°C Aria & Fluidi



-750mmHg ↔ Max 20 Bar

RoHS2



|      | G1/8 | G1/4 | G3/8 | G1/2 | G3/4 | G5/8 | N1/8 | N1/4 | N3/8 | N1/2 |
|------|------|------|------|------|------|------|------|------|------|------|
| 5/32 |      |      |      |      |      |      | •    | •    |      |      |
| 3/16 |      |      |      |      |      |      | •    | •    |      |      |
| 1/4  | •    | •    | •    |      |      |      | •    | •    | •    |      |
| 5/16 | •    | •    | •    |      |      |      | •    | •    | •    | •    |
| 3/8  |      | •    | •    | •    | •    | •    | •    | •    | •    | •    |
| 1/2  |      |      |      | •    |      |      |      |      | •    | •    |



| Construction Materials   | Materiali Costruttivi  |
|--|--|
| <p><b>Body:</b> EPDM<br/><b>Collet:</b> POM + SUS 301<br/><b>Seals:</b> EPDM suitable for food contact<br/><b>Cover:</b> POM</p>   | <p><b>Corpo:</b> EPDM<br/><b>Colletto:</b> POM + SUS 301<br/><b>Guarnizioni:</b> EPDM idoneo al contatto con alimenti<br/><b>Cover:</b> POM</p>  |
| <b>Data Sheet</b>  | <b>Dati Tecnici</b>  |
| <p><b>Type Fluids:</b> water, beverages, vacuum, compressed air, selected gases &amp; liquids<br/><b>Threads:</b> Taper gas BSPT ISO 7 from R1/8" to R1/2"<br/>Parallel gas BSPP ISO 228 from G1/8" to G1/2"<br/><b>Tubes Used:</b> PE, PA, PU, PTFE - FEP<br/><b>Soft metal tubes:</b> brass, copper and mild steel<br/><b>Hard metal tubes:</b> please contact our technical department for stainless steel and other hard materials tubes use</p> | <p><b>Fluidi Compatibili:</b> acqua potabile, bevande, vuoto, aria compressa, gas e liquidi<br/><b>Fillettature:</b> Gas conica BSPT ISO 7 da R1/8" a R1/2"<br/>Gas cilindrica BSPP ISO 228 da G1/8" a G1/2"<br/><b>Tubi da utilizzare:</b> PE, PA, PU, PTFE - FEP<br/><b>Tubi in metalli leggeri:</b> ottone, rame e acciaio dolce<br/><b>Tubi in metalli duri:</b> contattare l'ufficio tecnico per l'utilizzo con tubi in acciaio inox e altri metalli duri</p> |

|  |   |  |  |
|--|---|--|--|
|  <p><b>HPC</b></p> <p>HPC5/32-N01G HPC5/16-N03G<br/>HPC5/32-N02G HPC5/16-N04G<br/>HPC3/16-N01G HPC3/8-N01G<br/>HPC3/16-N02G HPC3/8-N02G<br/>HPC1/4-N01G HPC3/8-N03G<br/>HPC1/4-N02G HPC3/8-N04G<br/>HPC1/4-N03G HPC1/2-N03G<br/>HPC5/16-N01G HPC1/2-N04G<br/>HPC5/16-N02G</p> |  <p><b>HPC-R</b></p> <p>HPC1/4-R01G<br/>HPC1/4-R03G<br/>HPC3/8-R03G</p>  |  <p><b>HPC-MFL</b></p> <p>HPC3/8-MFL02G</p>   |  <p><b>HPC-G</b></p> <p>HPC3/16-G01G HPC5/16-G03G<br/>HPC1/4-G01G HPC3/8-G02G<br/>HPC1/4-G02G HPC3/8-G03G<br/>HPC5/16-G01G HPC1/2-G04G<br/>HPC5/16-G02G</p> |
|  <p><b>HCF</b></p> <p>HCF1/4-N01G<br/>HCF1/4-N02G<br/>HCF3/8-N02G</p>   |  <p><b>HCF-G</b></p> <p>HCF1/4-G04G<br/>HCF3/8-G04G<br/>HCF3/8-G05G<br/>HCF3/8-G06G<br/>HCF1/2-G04G<br/>HCF3/8-G05G-H</p>  |  <p><b>HCF-UN</b></p> <p>HCF3/8-UN1/2-16G</p>   |  <p><b>HCF-UNF</b></p> <p>HCF5/16-UNF7/16-20G<br/>HCF3/8-UNF7/16-20G</p>  |
|  <p><b>HPL</b></p> <p>HPL5/32-N01G HPL5/16-N03G<br/>HPL3/16-N01G HPL3/8-N02G<br/>HPL1/4-N01G HPL3/8-N03G<br/>HPL1/4-N02G HPL1/2-N03G<br/>HPL1/4-N03G HPL1/2-N04G<br/>HPL5/16-N02G</p>  |  <p><b>HMM</b></p> <p>HMM5/32-5/32G<br/>HMM1/4-1/4G<br/>HMM1/4-3/8G<br/>HMM5/16-5/16G<br/>HMM3/8-3/8G<br/>HMM1/2-1/2G</p>  |  <p><b>HCJ</b></p> <p>HCJ5/32-N01G HCJ5/16-N02G<br/>HCJ5/32-N01G HCJ5/16-N03G<br/>HCJ3/16-N01G HCJ3/8-N02G<br/>HCJ1/4-N01G HCJ3/8-N03G<br/>HCJ1/4-N02G HCJ1/2-N03G<br/>HCJ5/16-N01G HCJ1/2-N04G</p> |  <p><b>HGJ</b></p> <p>HGJ1/4-5/32G<br/>HGJ5/16-1/4G<br/>HGJ3/8-1/4G<br/>HGJ3/8-5/16G<br/>HGJ1/2-3/8G</p>  |
|  <p><b>HLJ</b></p> <p>HLJ5/32-5/32G HLJ5/16-5/16G<br/>HLJ3/16-3/16G HLJ3/8-5/16G<br/>HLJ1/4-1/4G HLJ3/8-3/8G<br/>HLJ3/8-1/4G HLJ1/2-1/2G</p>   |  <p><b>HUC</b></p> <p>HUC5/32-5/32G HUC5/16-5/32G<br/>HUC3/16-3/16G HUC5/16-1/4G<br/>HUC1/4-1/4G HUC3/8-1/4G<br/>HUC5/16-5/16G HUC3/8-5/16G<br/>HUC3/8-3/8G HUC1/2-5/16G<br/>HUC1/2-1/2G HUC1/2-3/8G</p> |  <p><b>HUL</b></p> <p>HUL5/32-5/32G HUL1/2-1/2G<br/>HUL3/16-3/16G HUL5/16-5/32G<br/>HUL1/4-1/4G HUL5/16-1/4G<br/>HUL5/16-5/16G HUL3/8-5/16G<br/>HUL3/8-3/8G HUL1/2-3/8G</p>                         |  <p><b>HUT</b></p> <p>HUT5/32-5/32G HUT3/8-3/8G<br/>HUT3/16-3/16G HUT1/2-1/2G<br/>HUT1/4-1/4G HUT3/8-1/4-3/8G<br/>HUT5/16-5/16G</p>                         |



HUY5/32-5/32G  
 HUY3/16-3/16G  
 HUY1/4-1/4G  
 HUY5/16-5/16G  
 HUY3/8-3/8G  
 HUY1/2-1/2G

**HUY**



HBU1/2-1/2G

**HBU**



HCJB1/4-1/4G  
 HCJG3/8-3/8G

**HCJB**



HLJB3/8-5/16G  
 HLJB3/8-3/8G

**HLJB**



HPP5/32G  
 HPP3/16G  
 HPP1/4G  
 HPP5/16G  
 HPP3/8G  
 HPP1/2G

**HPP**



HPF1/4G  
 HPF5/16G  
 HPF3/8G  
 HPF1/2G

**HPF**



HUFFG02-G06G  
 HUFFG03-G06G

**HUFF**



HCP04-5/32  
 HCP05-3/16  
 HCP06-1/4  
 HCP08-5/16  
 HCP10-3/8  
 HCP12-1/2

**HCP**