

SKUPP®

STAINLESS STEEL FITTINGS



SCSS SERIES

OUR STORY

In a market dominated by global players, SKUPP emerged from a clear need for change. The traditional supply chain in the industry, especially pneumatics and valve technology, had become increasingly complex, rigid, and inefficient. Distributors were confronted with shrinking margins, slow response times, and uncertain partnerships with established manufacturers. Smaller specialized production sites are also deminishing, which is bad for local business.

KEEP IT SIMPLE

SKUPP represents a more direct, transparent, and efficient approach. By maintaining substantial local inventories and providing full digital visibility into orders, stock levels, and product data, the supply chain becomes shorter and more reliable.

The result is a streamlined path from production to application — ensuring quality, speed, and accessibility in every connection.

Why choose SKUPP



Simplified Supply Chain
No unnecessary layers or delays

EU Stock Center
Large European stock enabling short delivery times



Standardized Product Range
A focused, consistent portfolio, to keep it simple

Clear Documentation
Clear data sheets and easy-to-learn product numbers



Predictable Partnerships
We aim for stable, long-term business relationships

Cost Efficiency
Competitive pricing while maintaining healthy margins



OUR RANGE

PNEUMATICS - CYLINDERS

Our cylinder range consists of the most-used cylinders in the industry, such as all common ISO standards. We also excel in helping customers with their demand for special cylinders, such as odd and extreme measurements, usage with (low-pressure) oil, or hollow rods. Is your example not listed? Challenge us!

PNEUMATICS - TUBING

Pneumatic tubing is available in various materials such as PA12, PA11, PU and PE to match application demands. Offered in many different colors and sizes, compatible with standard fittings.

PNEUMATICS - VALVES

Our valves for usage in pneumatic systems consist of the most commonly used versions, such as 3/2, 5/2, and 5/3 valves. Available as mechanically, manually, electrically, or pneumatically operated. Available in various port sizes, flow capacities, ISO standards and voltage options for pilot operation.

PNEUMATICS - FITTINGS

The range includes push-in fittings that can be divided into three categories based on the material used: plastic, nickel-plated brass, and stainless steel. The fittings are manufactured to precise tolerances to ensure leak-free connections within the rated pressure ranges. They are available in various thread standards (e.g., BSPP, BSPT, NPT) and shapes (straight, elbow, tee). Designed for easy installation with minimal leakage.

VALVES - BALL VALVES

SKUPP offers about twenty types of valves with various actuators and sealing designs, each featuring its own unique construction details. SKUPP ball valves are built for an expected lifetime of 70,000 to 100,000 cycles. Available with a body made of brass, stainless steel, or plastic and a threaded connection up to G2". Choose from different wiring configurations, such as with a Farah capacitor (Failsafe).

VALVES - CWS SOLENOID VALVES

The clear water solenoid valves are made of PA66-30 and have been successfully tested to up to 2,000,000 cycles. They are used as a cost-effective solution when high flow rates are not required. One of the most common applications is in vending machines and water dispensers.

SKUPP[®]
Keep it simple

TABLE OF CONTENTS

		PUSH-IN	BSPB	STEM	
SCSS01	Straight connector	●	●	●	Page 5
SCSS03	Elbow connector	●	●	●	Page 8
SCSS06	Elbow banjo		●		Page 12
SCSS08	Bulkhead	●			Page 13
SCSS09	Tee-connector	●	●		Page 14

SCSS01-G

MALE, STRAIGHT, BSPP

TECHNICAL FEATURES

MATERIAL

AISI 316L & FKM

PRESSURE

16 Bar

TEMPERATURE

from -20°C to 150°C

SUITABLE TUBING

PA polyamide

PU Polyurethane

CONNECTION

BSPP, metric tube

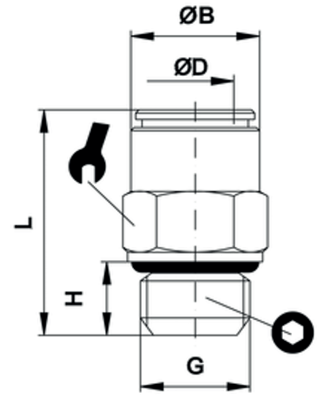

CODE	ØD	G	ØB	H	L		
------	----	---	----	---	---	---	--

SCSS01-04M5	4	M5	9	4	20,5	-	9
SCSS01-04G18		G1/8	9	5,5	19	3	13
SCSS01-06M5	6	M5	11	4	22,5	2,5	-
SCSS01-06G18		G1/8	11	5,5	23,5	4	13
SCSS01-06G14		G1/4	11	6,5	20	4	16
SCSS01-08G18	8	G1/8	13	5,5	26	5	13
SCSS01-08G14		G1/4	13	6,5	23	6	16
SCSS01-10G14	10	G1/4	15	6,5	27,5	7	16
SCSS01-10G38		G3/8	15	9	25,5	8	20
SCSS01-10G12		G1/2	15	9	29	8	23
SCSS01-12G14	12	G1/4	17	6,5	30	7	18
SCSS01-12G38		G3/8	17	9	31	10	20
SCSS01-12G12		G1/2	17	9	29	10	23

SCSS01- PUSH-IN CONNECTOR

TECHNICAL FEATURES

MATERIAL

AISI 316L & FKM

PRESSURE

16 Bar

TEMPERATURE

from -20°C to 150°C

SUITABLE TUBING

PA polyamide

PU Polyurethane

CONNECTION

Metric

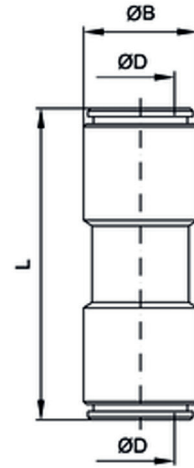

CODE	ØD	ØB	L
------	----	----	---

METRIC TUBE

SCSS01-0400	4	9	32
SCSS01-0600	6	11	35
SCSS01-0800	8	13	39
SCSS01-1000	10	15	39
SCSS01-1200	12	17	41

SCSS01S-

PUSH-IN, STEM

TECHNICAL FEATURES

MATERIAL

AISI 316L & FKM

PRESSURE

16 Bar

TEMPERATURE

from -20°C to 150°C

SUITABLE TUBING

PA polyamide

PU Polyurethane

CONNECTION

Metric

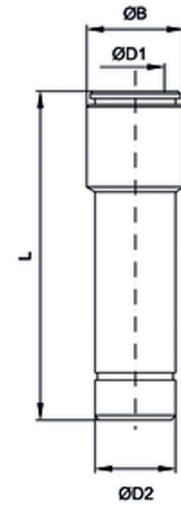

CODE	ØD1	ØD2	ØB1	L
------	-----	-----	-----	---

METRIC TUBE

SCSS01S-0604	6	4	9	30,5
SCSS01S-0806	8	6	11	33,0
SCSS01S-1008	10	8	13	38,5

SCSS03-G

SWIFEL ELBOW, MALE, BSPP

TECHNICAL FEATURES

MATERIAL

AISI 316L & FKM

PRESSURE

16 Bar

TEMPERATURE

from -20°C to 150°C

SUITABLE TUBING

PA polyamide

PU Polyurethane

CONNECTION

BSPP, metric tube

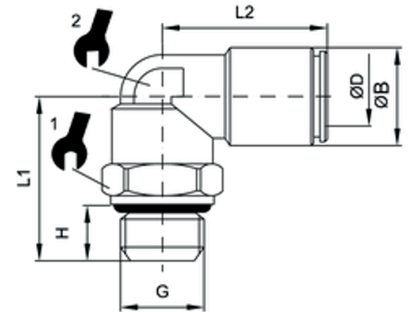

CODE	ØD	G	ØB	H	L1	L2		
------	----	---	----	---	----	----	--	---

SCSS03-04M5	4	M5	9	4	15	18	9	9
SCSS03-04G18		G1/8	9	5,5	19,5	20	13	10
SCSS03-04G14		G1/4	9	6,5	20,5	20	16	10
SCSS03-06M5	6	M5	11	4	14,5	20,5	9	9
SCSS03-06G18		G1/8	11	5,5	19,5	21,5	13	10
SCSS03-06G14		G1/4	11	6,5	20,5	21,5	16	10
SCSS03-08G18	8	G1/8	13	5,5	19,5	23,5	13	10
SCSS03-08G14		G1/4	13	6,5	20,5	23,5	16	10
SCSS03-10G14	10	G1/4	15	6,5	23	26,5	16	15
SCSS03-10G38		G3/8	15	9	26,5	26,5	20	15
SCSS03-12G14	12	G1/4	17	6,5	29	28,5	16	17
SCSS03-12G38		G3/8	17	9	28,5	28,5	20	17
SCSS03-12G12		G1/2	18,5	8,5	33,5	28	20	-

SCSS03-R

SWIFEL ELBOW, MALE, BSPT

TECHNICAL FEATURES

MATERIAL

AISI 316L & FKM

PRESSURE

16 Bar

TEMPERATURE

from -20°C to 150°C

SUITABLE TUBING

PA polyamide

PU Polyurethane

CONNECTION

BSPT, metric tube

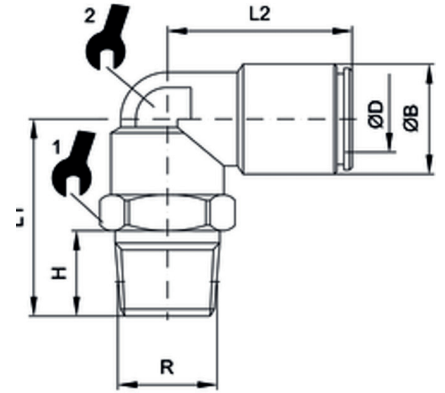

CODE	ØD	R	ØB	H	L1	L2		
------	----	---	----	---	----	----	---	---

SCSS03-04R18	4	R1/8	9	7	20,0	20,0	13	10
SCSS03-04R14		R1/4	9	11	25	20	10	14
SCSS03-06R18	6	R1/8	11	7	20,0	21,5	13	10
SCSS03-06R14		R1/4	11	11	25,0	21,5	14	10
SCSS03-08R18	8	R1/8	13	7	20	23,5	13	10
SCSS03-08R14		R1/4	13	11	25,0	23,5	14	10
SCSS03-10R14	10	R1/4	15	11	26	26,5	16	15
SCSS03-10R38		R3/8	15	11	30,0	26,5	15	17
SCSS03-12R14	12	R1/4	17	11	32,5	28,5	17	20
SCSS03-12R38		R3/8	17	11	32,5	28,5	17	20
SCSS03-12R12		R1/2	17	14	35,5	28,5	17	22

SCSS03-R...T

THREADED ELBOW, MALE, BSPT

TECHNICAL FEATURES

MATERIAL

AISI 316L & FKM

PRESSURE

16 Bar

TEMPERATURE

from -20°C to 150°C

SUITABLE TUBING

PA polyamide

PU Polyurethane

CONNECTION

BSPT, metric tube

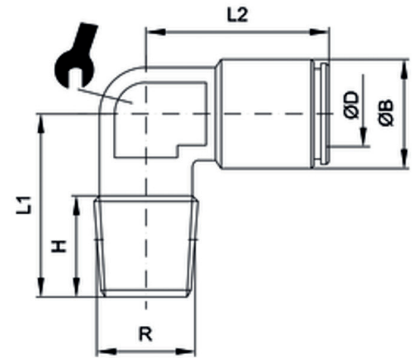

CODE	ØD	G	ØB	H	L1	L2	 ¹
------	----	---	----	---	----	----	---

SCSS03-04R18T	4	R1/8	9	7,5	14	18,5	9
SCSS03-06R18T	6	R1/8	11	8	17	20,5	11
SCSS0306R14T		R1/4	11	11,5	20	20,5	11
SCSS03-08R18T	8	R1/8	13	8	17	22,5	11
SCSS03-08R14T		R1/4	13	11	20	22,5	11

SCSS03- ELBOW, PUSH-IN

TECHNICAL FEATURES

MATERIAL

AISI 316L & FKM

PRESSURE

16 Bar

TEMPERATURE

from -20°C to 150°C

SUITABLE TUBING

PA polyamide

PU Polyurethane

CONNECTION

Metric tube

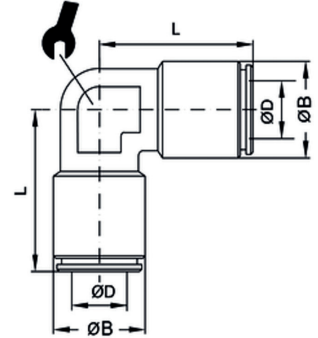

CODE	ØD	ØB	L	
------	----	----	---	---

METRIC TUBE				
SCSS03-0400	4	9	17,5	9
SCSS03-0600	6	11	20,5	11
SCSS03-0800	8	13	22,5	11
SCSS03-1000	10	15	25	15
SCSS03-1200	12	17	27	15

SCSS06-G

BANJO, BSPP

TECHNICAL FEATURES

MATERIAL

AISI 316L & FKM

PRESSURE

16 Bar

TEMPERATURE

from -20°C to 150°C

SUITABLE TUBING

PA polyamide

PU Polyurethane

CONNECTION

BSPP, metric tube

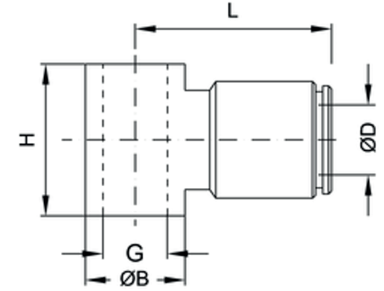

CODE	ØD	G	ØB	H	L
------	----	---	----	---	---

SCSS06-04G18	4	G1/8	14	15	20,5
SCSS06-06G18	6	G1/8	14	15	22,5
SCSS06-06G14		G1/4	18	17	24
SCSS06-08G18	8	G1/8	14	15	23
SCSS06-08G14		G1/4	18	17	25,5

CODE	G	H1	H2	L	
------	---	----	----	---	---

SCSS06-BG18	G1/8	9,5	15,5	29,0	14
SCSS06-BG14	G1/4	9,0	17,5	32,5	17

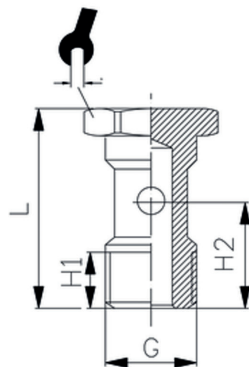

SCSS08- PUSH-IN, BULKHEAD

TECHNICAL FEATURES

MATERIAL

AISI 316L & FKM

PRESSURE

16 Bar

TEMPERATURE

from -20°C to 150°C

SUITABLE TUBING

PA polyamide
PU Polyurethane

CONNECTION

Metric tube

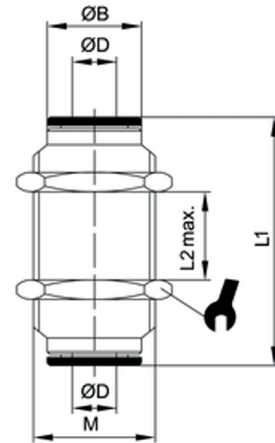

CODE	D	ØB	M	L1	L2 MAX	
SCSS08-0400	4	9	M12x1	32	11	15
SCSS08-0600	6	11	M14x1	34	16	17
SCSS08-0800	8	13	M16x1	37	17	19
SCSS08-1000	10	15	M18x1	39,5	21	21
SCSS08-1200	12	17	M20x1	41	20	24

SCSS09-G

CENTRAL-TEE SWIVEL, MALE, BSPP

TECHNICAL FEATURES

MATERIAL

AISI 316L & FKM

PRESSURE

16 Bar

TEMPERATURE

from -20°C to 150°C

SUITABLE TUBING



PA polyamide

PU Polyurethane

CONNECTION

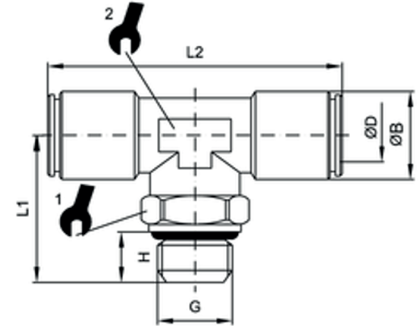
BSPP, metric tube



CODE	ØD	G	ØB	H	L1	L2		
SCSS09-04M5	4	M5	9	4	20,5	36	9	9
SCSS09-04G18		G1/8	9	5,5	25,5	36	13	11
SCSS09-06G18	6	G1/8	11	5,5	25	43	13	11
SCSS09-06G14		G1/4	11	6,5	26	43	16	11
SCSS09-08G18	8	G1/8	13	5,5	25	47	13	11
SCSS09-08G14		G1/4	13	6,5	26	47	16	11
SCSS09-10G14	10	G1/4	15	6,5	23,5	51	16	15
SCSS09-10G38		G3/8	15	9	27	51	20	15

SCSS09- TEE, PUSH-IN

TECHNICAL FEATURES

MATERIAL

AISI 316L & FKM

PRESSURE

16 Bar

TEMPERATURE

from -20°C to 150°C

SUITABLE TUBING

PA polyamide
PU Polyurethane

CONNECTION

Metric tube

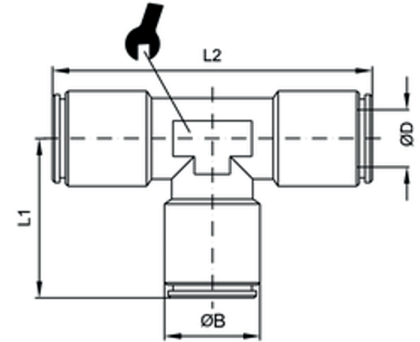

CODE	ØD	ØB	L1	L2	
SCSS09-0400	4	9	18	36	9
SCSS09-0600	6	11	20,5	41	11
SCSS09-0800	8	13	22,5	45	11
SCSS09-1000	10	15	25	50	15
SCSS09-1200	12	17	26,5	53	15

SKUPP[®]
Keep it simple